

Product Specification

HOP-TRB-ARL-A00-NS1 Ver: 2.0

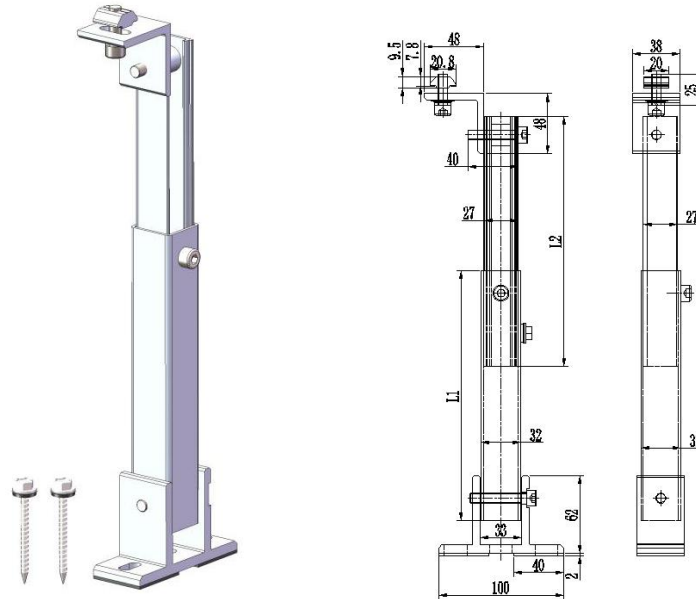

No.	Part No.	Feature Size			Weight(kg)	Packing	Carton size
		α	L1	L2			
1	TRB-ARL-A15-NS1	10~15°	200	200	0.549	40pcs	540×220×380
2	TRB-ARL-A30-NS1	15~30°	360	360	0.721	20pcs	540×220×380
3	TRB-ARL-A60-NS1	30~60°	660	660	1.045	20pcs	540×220×730

Name Adjustable Rear Leg

Stock Code TRB-ARL-A00-NS1

Weight(g) See above table

BOM

- HOP-H81-0038 (AL6005-T5) x 1
- HOP-J03-0038 (AL6005-T5) x 1
- HOP-J05-0000 (AL6005-T5) x 1
- HOP-J07-0000 (AL6005-T5) x 1
- HOP-J68-0021 (AL6005-T5) x 1
- HOP-G91-0020 (AL6005-T5) x 1
- HOP-G94-0020 (AL6005-T5) x 1
- HOP-K03-0040 (EPDM) x 2
- ST6.3*25 Self-tapping screw(SUS 410) x 1
- ST6.3*80 Timber screws (20# dacromet) x 2
- M8*20 Hexagon socket head cap screws (SUS304) x1
- M8*25 Hexagon socket head cap screws (SUS304) x1
- M8*40 Hexagon socket head cap screws (SUS304) x1
- M8*45 Hexagon socket head cap screws (SUS304) x1
- d8 Spring washers (SUS304) x 1
- M8×13 Ribbed Lock washers (SUS304) x 1

Packing See above table

Carton size See above table